



UBA

P-C氣動精密單向閥泵



P-C 氣動精密單向閥泵

- P-C系列氣動單向閥型計量泵，採用精密的單向閥設計，適合用於各種不含顆粒的中低年度異體的定量注液。
- 千分尺容量微分頭和整體內置配裝的速度控制器，能精準控制注液量和注液速度，實現在各種條件要求下的計量注液。
- 該系列的計量泵具有極高的計量精度與重覆一致性；精度優於正負千分之五。
- 標準泵型全316不鏽鋼結構，泵的所有零件都有更好的耐腐蝕性。在實際鋰離子電子注液和其他工業應用中，耐腐蝕性能優於進口計量泵。
- P-4系列配備特別設計的電器聯控系統，配合氣動傳感器，注意完成自動回程。專利設計的內置速度控制單元，整機更緊湊。可靠的氣控閥，沒有氣閥洩漏的煩惱。

應用：電解液、電子煙油、熱管超純水、香水、洗髮水化學液體、藥液、溶劑、精油、精華液等。

P1-C / P2-C 系列

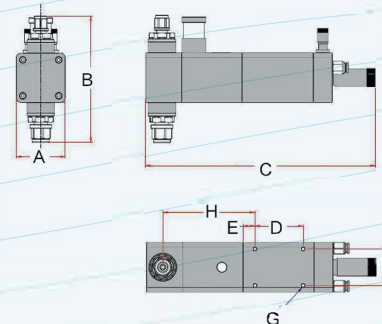

型號 Model	柱塞直徑 Plunger Dia	行程 Stroke	注液量范围 Dispensing Vol	循環速度 Cycle Rate	耗氣量 Air Consumption	外形尺寸 (MM) Dimension (MM)								重量 (KG) Weight (KG)
	MM					ML	次 / 分鐘 CCP	升 / 分鐘 L/Min	A	B	C	D	E	
P1-C03	4.7	12.7	0-0.23	0-150	12.5	45	103	205	42.7	17	32	8-32	80	2.5
P1-C05	7.9		0-0.63											
P1-C07	11.1		0-1.2											
P1-C10	15.9		0-2.5											
P2-C10	15.9	25.4	0-5.0	0-120	23.5	52	134	268	63.5	12.7	38	8-32	97	3.2
P2-C12	19.1		0-7.2											
P2-C14	22.2		0-9.8											
P2-C17	27.0		0-14.5											
P2-C20	31.8		0-20.1											

UBA Pneumatic Check Valve Pump

The UBA Check Valve Style Dispensing Pumps are designed for dispensing low to medium viscosity liquid not containing particles.

Precise micrometers volume adjustment and built-in speed control system ensures dispensing accuracy and plunger motion speed control, by which the pumps are suitable for different working condition. Typical accuracy is within ± 0.5 .

Complete 316 stainless steel pump construction. All pump parts have better rot-proof performance compare with imported pumps, especially on Li-Ion electrolyte application.

P4-C series pumps have special pneumatic-electric control unit with forward position sensor. The plunger may return automatically after complete dispensing stroke. Patent build-in speed control unit makes the pump more compact. Reliable pneumatic-electric valve ensures no leakage operation.

Application: Electrolyte, E-Cigarette Oil, Hot Pipe Water, Perfume, Pan Ink, Shampoo, Chemical Liquid, Medicine, Solvent, Essential oil and more.....

P3-C / P4-C 系列

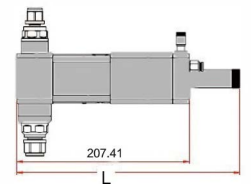
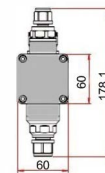
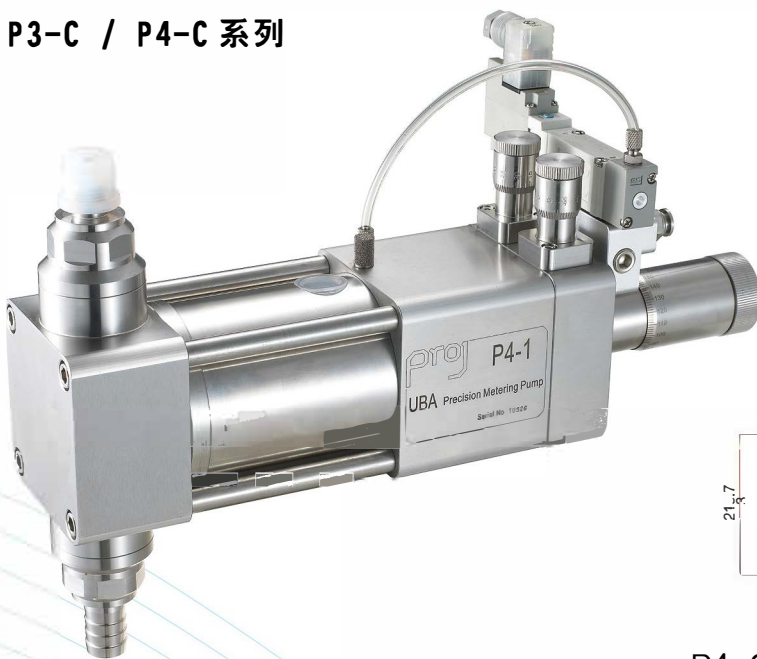

P3-C

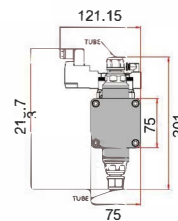
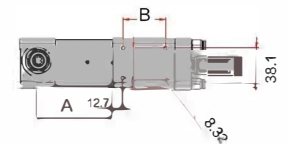

P4-C

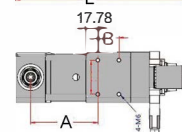
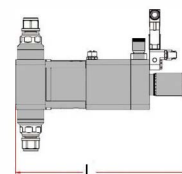

型號 Model	柱塞直徑 Plunger Dia	行程 Stroke	注液量範圍 Dispensing Vol	循環速度 Cycle Rate	耗氣量 Air Consumption	外形尺寸 (MM) Dimension (MM)			重量 (KG) Weight (KG)
	MM	MM	ML	次/分鐘CCP	升/分鐘L/Min	A	B	L	
P3-C20	31.8	38.1	0-30	0-70	40	125	50.8	268	5
P3-C26	41.3		0-50						
P4-1-C34	54.0	25.4	0-58	0-150	51	101	31.75	263.2	6.8
P4-2-C34	54.0	50.8	0-116	0-120	85	129.7	50.8	339.4	7.6
P4-3-C34	54.0	76.2	0-174	0-90	102	167.76	50.8	416.2	8.3
P4-4-C34	54.0	114.3	0-261	0-60	115	205.9	50.8	441.5	9.8